



Lindford Farm

LINDFORD





*The quintessential
country retreat*

A charming gabled farmhouse



Pretty as a picture, Lindford Farm is a country retreat and presents a unique opportunity for a discerning buyer to purchase a charming, gabled farmhouse on seven tranquil acres with sunny, south-facing gardens, dreamy river frontage and glorious pastoral views.

A much-loved family home for the current owners, it has been an idyllic spot to bring up their family and a fantastic social hub for entertaining. Lindford Farm is a wonderful base for hosting large Christmas parties and summer gatherings around the pool and tennis court, wading and fishing in the river, or simply sunbathing on the terraces while children play on the lawns.

Dating from circa 1750, this fabulous 2,500 sq ft house boasts four bedrooms, two bathrooms, a study landing, drawing room, dining kitchen, prep kitchen, reception hall, pantry, utility room and downstairs cloakroom. The grounds include mature gardens, a tennis court, swimming pool, two paddocks, a restored annexe, a period barn and garage block (with potential to convert), and an area of woodland teeming with birds and wildlife.

The house has been updated over the last few years. It has benefited from extensive re-roofing, rebuilt gables, new kitchen and bathrooms, new double-glazing on many windows, and the addition of two effective wood burners.



Making an entrance



A country lane leads up to the private gate and onto the gravel courtyard in front of the house, with parking for several cars.

A traditional front door opens into a welcoming reception hall offering an uplifting view out to the gardens.

The inner hall leads to the spectacular reception rooms, which have been cleverly reconfigured to maximise space and views of the garden. This creates a bright, open-plan living space spanning some 69 feet. When required, the rooms can be separated using conveniently hidden pocket doors between the dining and drawing rooms.

The modern kitchen retains a cosy cottage feel. Throughout the ground floor, many characterful period features, such as the original parquet and tiled flooring, remain.



Entertain in style



To the right of the hall is a sizeable dual-aspect drawing room with a feature bay window on one side and an enlarged fireplace with an efficient wood burner as the focal point. There's plenty of seating around it for gathering large groups of family and friends, making this a wonderful, entertaining and relaxing room.

Large south-facing windows on the other side give captivating views across the lawns and gardens to fields beyond. Through the French doors, you step onto the expansive terrace under a wisteria-clad pergola. Comprising a sitting and dining area with an enchanting vista, the terrace is a wonderful sun trap, perfect for sitting back with a glass of wine or enjoying a quiet morning coffee. You can take in the gardens sloping gently to the picturesque river frontage and be tempted by the turquoise heated pool that basks in the summer sun until the end of the day.





Heart of the home



To the left of the reception hall is the bright, open-plan dining kitchen, which can be divided from the hall by concealed pocket doors. With space to accommodate a long dining table, this room also offers an appealing outlook over the garden, and a wood burner ensures it is an inviting space for winter evening dinners or big Sunday lunches.

The kitchen, with its original tiled floor, combines a country feel with a gold leaf splashback for a mellow bohemian glamour. A central island provides additional worktop space as well as a sociable place to gather and chat whilst meals are prepared. When entertaining, messier jobs can be carried out in the useful prep kitchen at the far end, conveniently tucked away. The kitchen includes a large Rangemaster cooker with an electric hob, an extraction hood, a large American-style fridge/freezer and a deep Belfast sink.

Off the kitchen is a separate laundry/boiler room with extra storage space, plus a back hall with an enviable walk-in pantry, a boot store, a coat cupboard, a guest cloakroom, and access to the back door.







Sweet dreams



Upstairs, the spacious primary bedroom boasts views on three sides, with a particularly entrancing aspect down the lawn to the river frontage. There's a built-in wardrobe and shelving for clothes, as well as lots of room for a super king-sized bed, a sofa, dressing table, and bookshelves.

The second double bedroom benefits from the same lovely southerly outlook over the garden and a modern en suite shower room.

The large third double bedroom has dual views and plentiful built-in wardrobe space, while the fourth sweet double is like a boutique hotel snug, with views of the river while lying in bed.

The broad upstairs landing is used by the current owners as a study area, but it could equally be a snug/teenage PlayStation zone instead. There are two ample built-in cupboards ideal for storing sheets and towels.

The large family bathroom is an alluring space with sophisticated antiqued mirrors, twin basins, reclaimed encaustic Spanish tiles, and cosy underfloor heating. Perfect for a soothing evening soak!







Exceptional outbuildings



Immediately adjacent to the main house is the large period barn (currently used as a gym/store, garden store and garage). This sizeable building (741 sq ft) has the potential to be developed into an additional annexe with 2–3 bedrooms or as a fantastic party barn (subject to planning permission).

Directly opposite the main house is an enchanting annexe/home studio with its own sweet forecourt. It was renovated from an original pig sty and is currently used as a separate home office. It benefits from a Wi-Fi link from the main house.





Glorious gardens & grounds



Approximately 0.7 of an acre of established south-facing lawn and gardens lead down to the river, and a fabulous swimming pool captures the sun all day and into the long summer evenings. Stay refreshed during the hot months with a morning dip in the pool or host guests for poolside cocktails or sundowners.

Enjoy a regular game of tennis or organise a family tournament on the tennis court next to the pool. When it's really hot, you can go from the court straight in for a swim!

The privacy and seclusion of this gorgeous house mean you can either lose yourself in peace and tranquillity or make as much noise as you like!

With nearly half a mile of private river frontage, it offers the freedom to wade and fish in the River Wey and explore the natural woodland and wildlife along the river bank that forms part of the seven acres in this fabulous property.

For riders wishing to keep horses, there are two large paddocks and a large garden store that could be converted into stables (subject to the relevant permissions).







Love where you live



Lindford is a popular village in East Hampshire, on the edge of Headley, which offers numerous day-to-day facilities and entertainments, including a post office, a cricket club with men's, ladies' and youth teams, a farm shop, pub, village hall, tea rooms and coffee shop, bowling and table tennis clubs as well as an active church.

Plenty of outdoor pursuits are available nearby, including numerous country walks, cycling routes and bridleways, with walks directly from the house to the woods or Broxhead Common.

For commuters, the main line station at Liphook is just 4 miles away, Haslemere and the historic market town Farnham station are both 8 miles away; trains go direct to London Waterloo in about an hour.

There is quick and easy road access to the A31 heading towards Winchester, the A3 to head up to the M25 or into London, or alternatively, the A3 to head south to the nearby coast and beaches.

Local primary school options include Holme C of E Primary School (OFSTED rated 'Good') and Bordon Infant School (Good) or independent prep schools, Highfield and Brookham, Edgeborough, More House, Amesbury, Bedales Prep Dunnanie and Churcher's College Prep. Secondary schools nearby include Oakmoor School (Good). Independent options include Alton School, Frensham Heights, Lord Wandsworth, Charterhouse, Bedales and Churcher's College.

Floorplans



MAIN HOUSE: 2,500 sq ft (232.2 sq m)
 ANNEXE: 270 sq ft (39.3 sq m)
 GARAGE: 423 sq ft (39.3 sq m)
 GARDEN STORE: 78 sq ft (7.3 sq m)
 BARN/GYM: 240 sq ft (22.3 sq m)
 TOTAL: 3,511 sq ft (326.2 sq m)

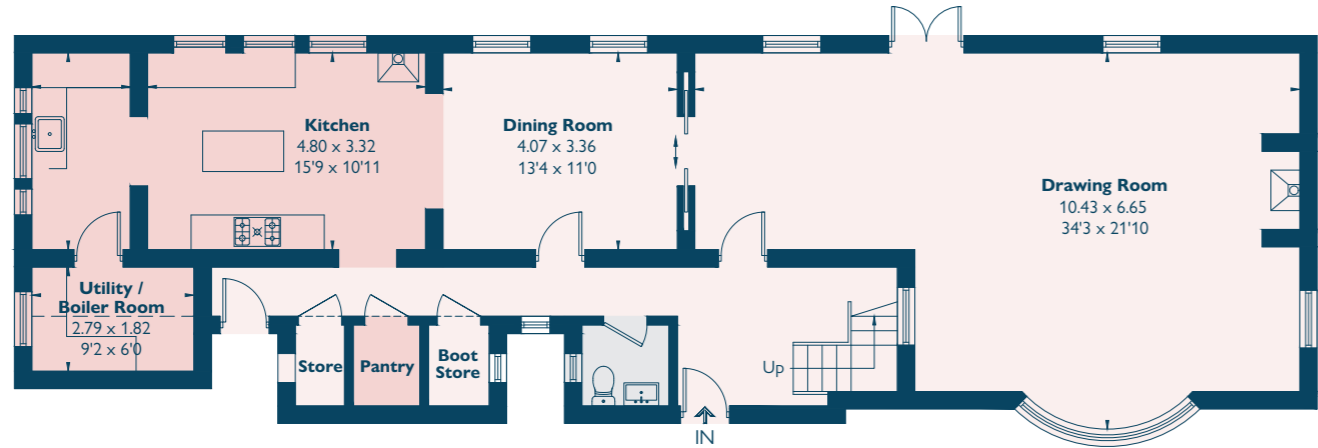

MAIN HOUSE
First Floor

Floorplans

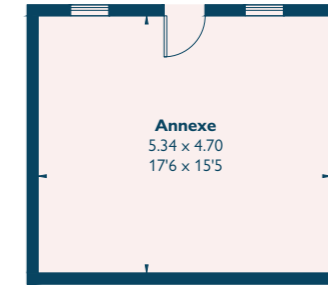

ANNEXE
(not shown in actual location/orientation)

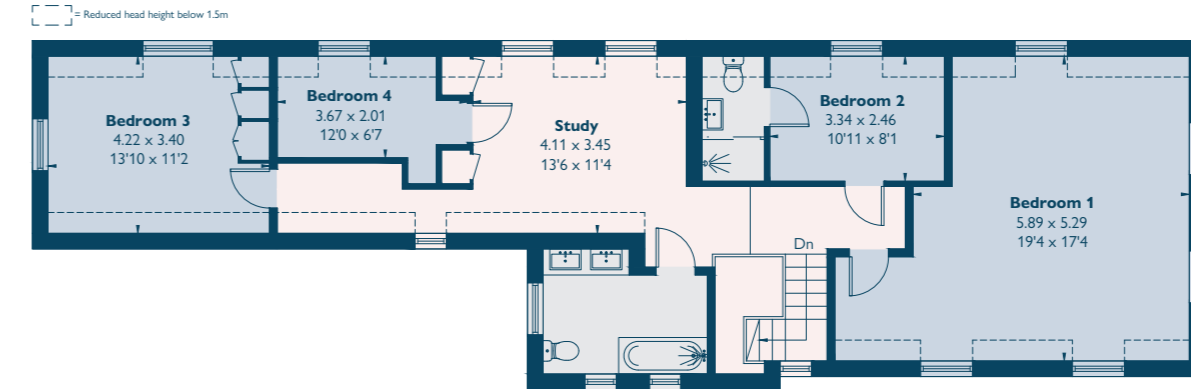

MAIN HOUSE
Second Floor

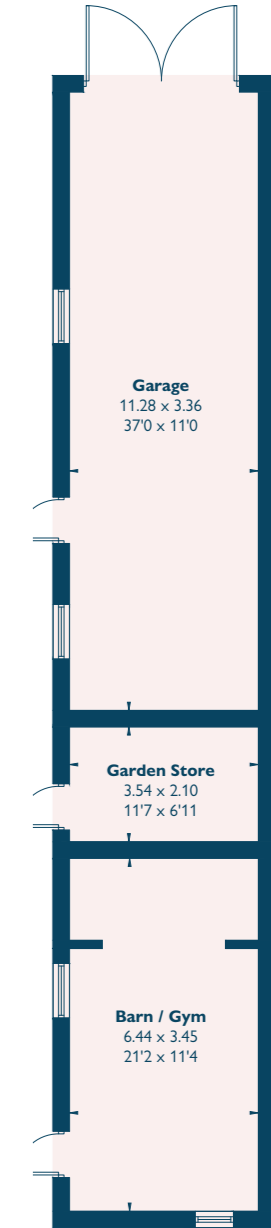

OUTBUILDINGS
(not shown in actual location/orientation)

Finer details

OVERVIEW

- Picturesque country house set in a tranquil location
- Southerly gardens and country views in all directions
- Grounds of 7.2 acres, including attractive gardens of 0.7 acres
- Four bedrooms, including the principal bedroom
- Fabulous interconnecting 69 ft, South facing drawing room, dining room, kitchen and prep kitchen
- Separate utility room, boot room and walk-in pantry
- Over the past few years, the house has benefited from extensive investment. Most of the roof and gables, as well as the bathrooms and kitchen, have been replaced.
- Separate annexe/home office
- Tennis court
- Heated swimming pool
- Nearly 1/2 mile of private river frontage on River Wey (with secure fencing)
- Large period barn, store room and garage with potential to convert (subject to planning permission)
- No listing restrictions

ENERGY PERFORMANCE

Score	Energy rating	Current	Potential
92+	A		
81-91	B		90 B
69-80	C		
55-68	D		
39-54	E	42 E	
21-38	F		
1-20	G		

GARDENS & GROUNDS

- Heated swimming pool
- Tennis court
- Mature lawns and garden approx 0.7 acre
- South-facing terrace, an ideal spot to enjoy a coffee or a glass of rosé
- Nearly 1/2 mile of private river frontage on River Wey (with secure fencing)
- Huge south-facing covered dining terrace
- 2 paddocks
- Large garden store with the potential to convert to stabling
- Natural woodland
- Vegetable growing area
- Private gated driveway with parking for several cars

SERVICE & FEATURES

- Mains electricity and water
- Private drainage into septic tank
- Oil-fired central heating
- Megaflow hot water system
- U-Switch quote internet options up to 67mpbs

IN THE AREA

- Just 3 minutes drive to everyday facilities and sports clubs in Lindford and Headley
- 12 minutes to Liphook station with direct trains to London Waterloo in an hour
- Just 20 minutes to the thriving market towns of Farnham, Haslemere and Petersfield
- Close to numerous good state and private schools
- Quick and easy road access to A31 and A3
- There are lots of lovely walks and country pursuits nearby

Ingham Fox use all reasonable endeavours to supply accurate property information. These property details do not constitute any part of the offer or contract and all measurements are approximate. The matters in these particulars should be independently verified by prospective buyers. It should not be assumed that this property has all the necessary planning, building regulation or other consents. Any services, appliances and heating system(s) listed have not been checked or tested. Purchasers should make their own enquiries to the relevant authorities regarding the connection of any service. No person in the employment of Ingham Fox has any authority to make or give any representations or warranty whatever in relation to this property or these particulars or enter into any contract relating to this property on behalf of the seller.





Lindford Farm

LINDFORD

Lindford Farm, Lindford Road, Lindford, Hampshire GU35 0NX
what3words ///listening.nobody.overlooks



INGHAM FOX
UNIQUE HOMES

01428 786321 • nick@inghamfox.com • inghamfox.com

To view, please WhatsApp, message or call Nick Fox on 07790 020492